

RX28

WORLDS EDITION

ASSEMBLY INSTRUCTIONS

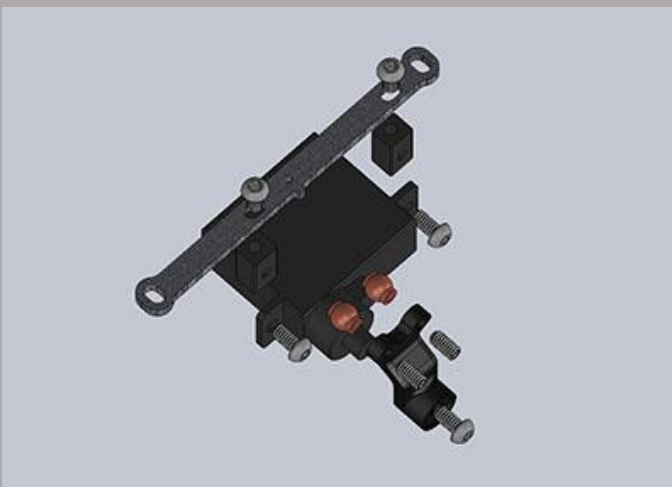
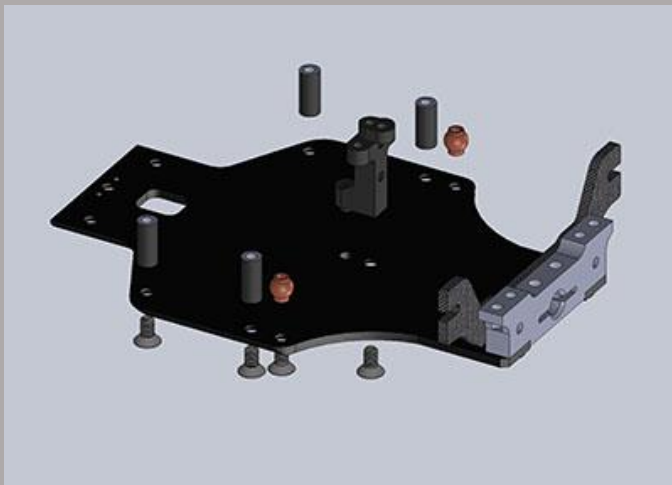
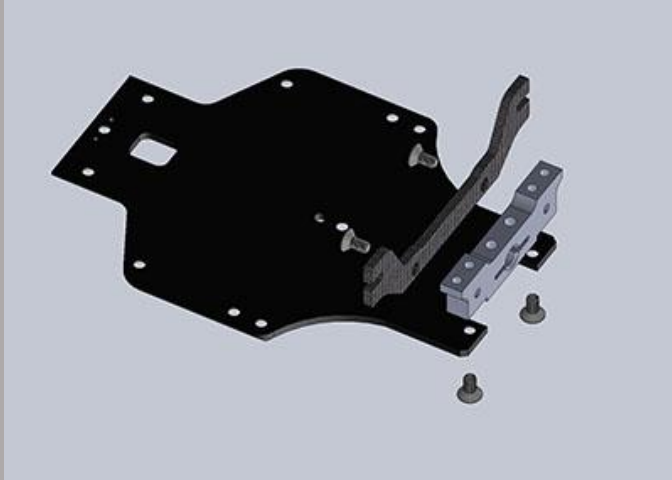

Welcome to the assembly instruction manual for the RX28 G2 “World’s Edition”. This latest update on the kit adds the 24mm battery compatible chassis. All else is the same as the “Champions Edition”.

To start, you will use 4 pcs of the M2x4CS Screws (RX28-023) to install the Pivot (RX28-050) and the Body Clip (RX28-032).

Install 4 pcs of the 7mm threaded posts (RX28-062) with 4 x M2x4CS (RX28-023). Install 2 pcs of the 3.5mm threaded pivot ball (RX28-017) with 2pcs of M2x3CS (RX28-024). Additionally, install the Center Shock Mount (RX28-063) with a M2x4CS. **Note:** Space this mount up with the provided steel shims (RX28-064) to ensure your battery fits under the holder.

To assemble the servo, (**SERVO IS NOT INCLUDED**-we recommend the Reflex Racing RRE007 on all your builds) you will install the posts (RX28-037) on the CF Brace (RX28SE-03) with 2pcs M2x4CS, take note of the orientation of the posts, they are offset set it max forward and don’t fully tighten them. Install the Posts onto the servo ear using 2 pcs of M2x4BH (RX28-022). Before you install the servo horn, install 2pcs of 3.5mm threaded pivot balls (RX28-017) with 2pcs of M2x4 Set Screws (RX28-039). Next Proceed to install the horn on the servo with an M2x4BH screw. This can be tight, so use a longer screw to start pressing it in if needed.

After this Center the servo on the brace against the horn. You can then tighten the posts.

RX28

WORLDS EDITION

ASSEMBLY INSTRUCTIONS

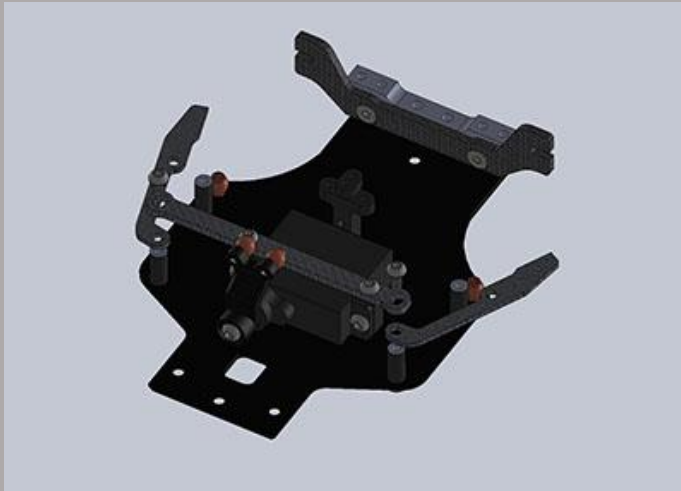

Now install the chassis braces (RX28-065) on top of the front 7mm posts. Then install the servo assembly on top and secure in place with 2pcs of M2x4BH (RX28-022).

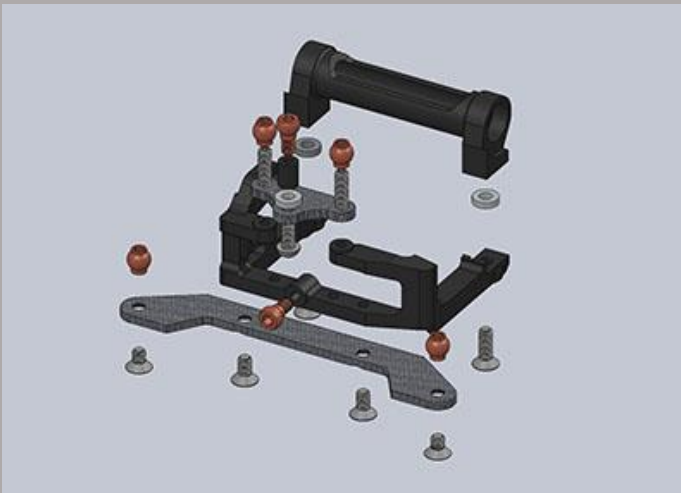

Move to the rear end. Install the motor mount plate (RX28-053) with 2x M2x4CS (RX28-023). Install 2x 3.5mm Threaded Pivot Balls (RX28-017) with 2x M2x3CS (RX28-024) on the motor mount plate. Next, use a 3.5mm Ball Stud (RX28-018) in the forward-facing thread on the motor mount, it is good practice to use a light thread lock here. To attach the upper shock mount, use 2pcs of the M2x6 Set Screws (RX28-040) and thread them into the top of the motor mount. Use some thread lock to secure these. Next Secure the Center Shock 4mm (RX28-036) Post to the Carbon Fiber Mount (RX28-029) with an M2x4BH, but space it up with a M2x1 shim).



Tighten the Center Shock Mount with 2 pcs of the 3.5mm Threaded Pivot Balls (RX28-017). Lastly, install the rear axle carrier with 2 pcs of the M2x6CS (RX28-047). Space the carrier up with an M2x1 shim to start.

RX28

WORLDS EDITION

ASSEMBLY INSTRUCTIONS

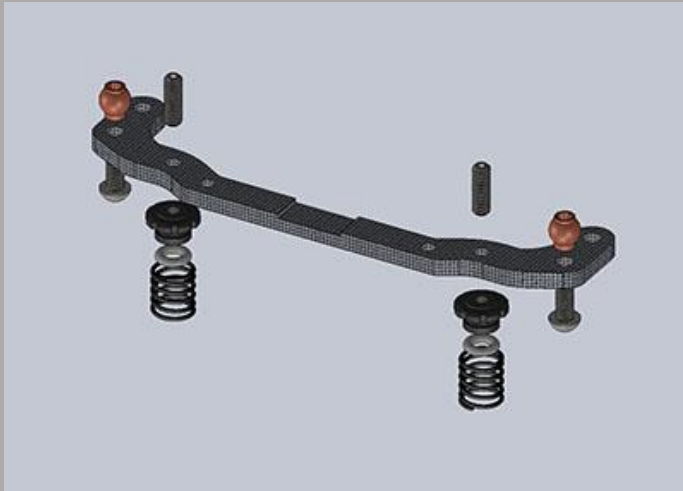

Prepare the Rear Tweak Brace First (RX28-030). Thread 2pcs of the M2x6 (RX28-040) Set Screws into the CF. Leave about 1.5mm sticking above the CF. **PLEASE NOTE:** If the Set Screws are not threading in easier, STOP! Use a bigger head screw like an M2x4BH and pre thread the hole. Install the 2pcs of the 3.5mm Threaded Ball with 2x M2x4BH Screws.

On the Spring Perches (RX28-011), Slide the O-ring over the groove, clip in the provided black springs (RX28A-04) and then spin the perch onto the Set Screw on the Brace. Use Loctite to secure the Perch to the Screw. The perch should not spin on the screw. The adjustment will come from the top with a 0.9 allen wrench.

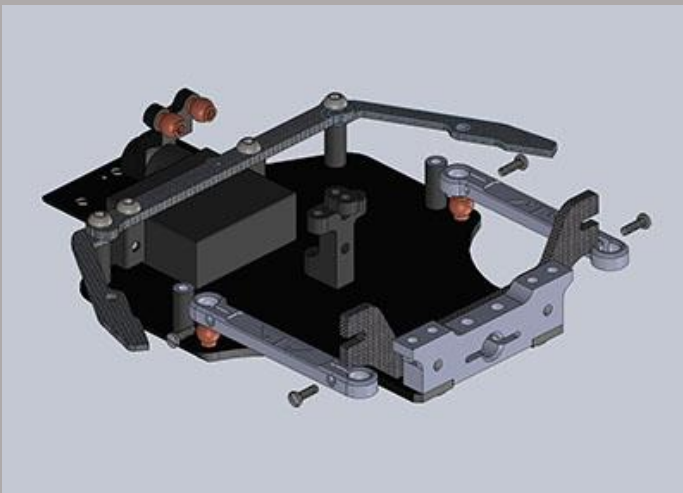

Now pop in the Side links (RX28-049) into the front Pivot balls. Attach the tightening M1.2x4 Screws (RX28-041) but do not tighten them all the way.

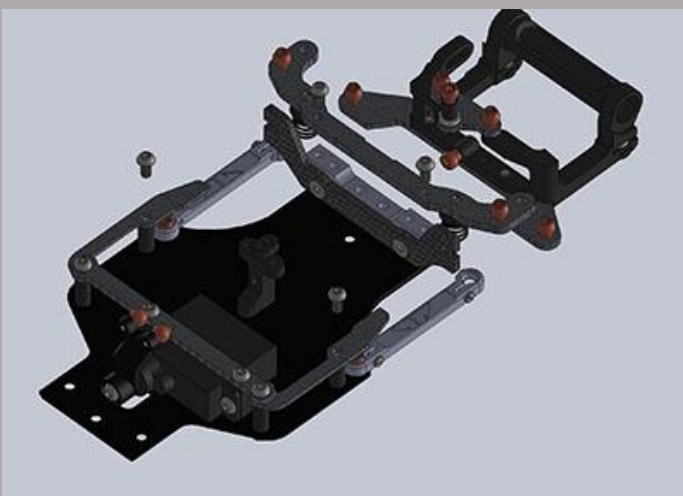

Line up the chassis braces over the rear 7mm posts and tighten with 2 pcs of the M2x4BH (RX28-022). Insert the pivot ball into the pivot and pop in the back 2 balls into the side links.

RX28

WORLDS EDITION

ASSEMBLY INSTRUCTIONS

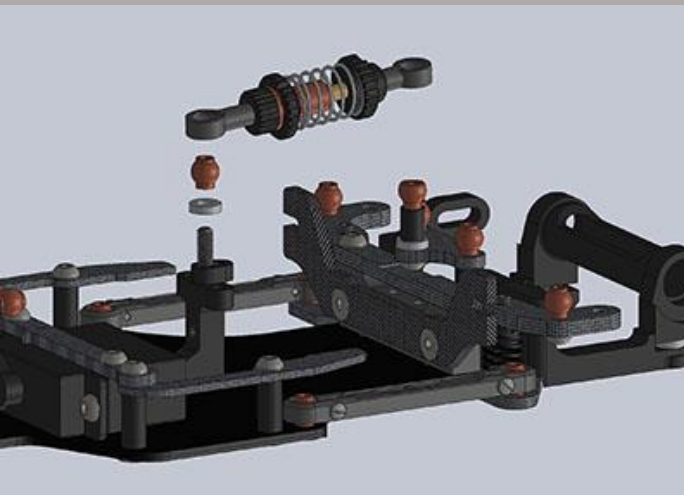

Assemble the Center Shock as per the image on the left. Thread a ball cup (RX28-052) on the cap and one on the spring perch. Apply some 15,000 CST Fluid to the Shaft and Slide it into the shock body. Thread the adjustment collar onto the body. It is designed to be tight. This is why it is split, so the settings are not lost.

The spring will be held in place with the perch at the bottom. Tighten the perch onto the Shaft with an M2x2 Set Screw (RX28-038).

Install a 3.5mm Threaded Pivot Ball (RX28-017) along with an M2x4 (RX28-039) and an M2x1 Shim into the front hole of the forward, center shock mount. Pop the ball cup on the cap side of the shock into that pivot ball and the rear pivot ball into the rear 3.5mm Ball Stud Previously installed on the Rear, Center Shock Mount.

To build the Side Dampers (RX28-054) Thread a 3.5mm Ball Cup (RX28-052) into the Piston. Apply 15,000 CST Fluid on the piston and work it into the body side.

ASSEMBLY INSTRUCTIONS

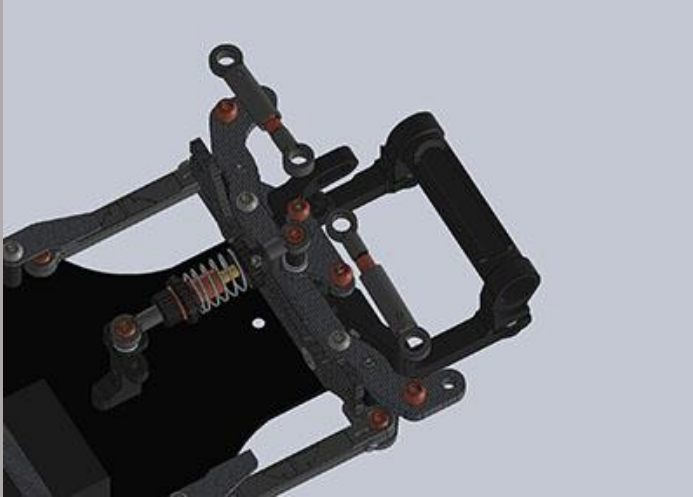

Pop the Side dampers onto the pivot balls on the car.

BALL DIFF

Assemble the diff in the order in the images on the left.

Some notes:

-The thrust bearing (RX515V2-2) has 2 different OD washers. The larger diameter goes inside the outer aluminum diff housing. The smaller one goes right under the E-Clip (RX407). Apply a generous amount of Reflex Racing Blue Thrust Grease (RX412) on the caged bearing (gold part with the balls) when installing.

-Apply some Reflex Racing Ball Diff Grease (RX414) on the diff balls before assembly.

-When installing the outer wheel, don't overtighten the wheel nut. This has a small additional adjustment range on the diff tension. Tighten the wheel nut all the way down and back off half tun. Then adjust the diff so it has a little slip under acceleration. At this point, use the outer nut to get the engagement you want.



RX28

WORLDS EDITION

ASSEMBLY INSTRUCTIONS

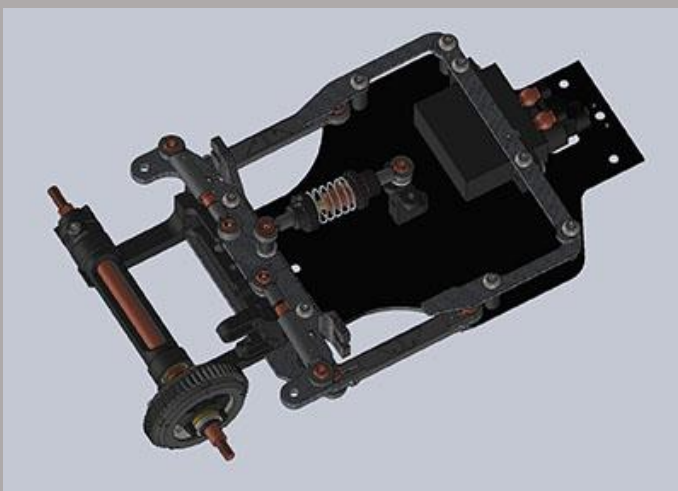
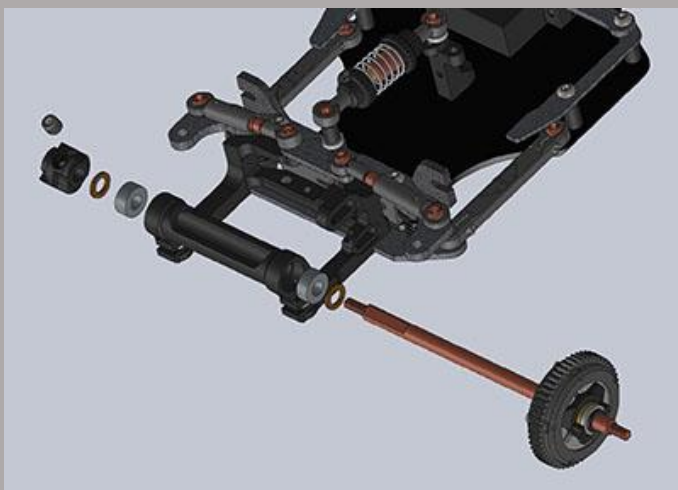

Once the diff is assembled. Install it in the rear axle carrier. Use the provided M3x0.5 axle shims (RX501) to adjust track width. The starting set up is 1pc on each side (there is an extra one provided in case you lose one). Narrower rear will give more rotation, wider will be more stable.

Use the M3x2 set screw into the left hub and leave about a 0.2 mm gap of play on the axle. Be carefull when tightening the left rear wheel as overtightening will make the rear hub move and bind the rear axle.

RX28

WORLDS EDITION

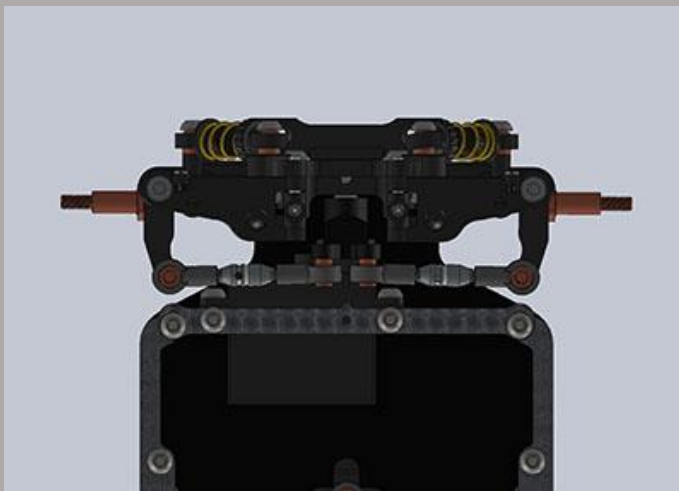
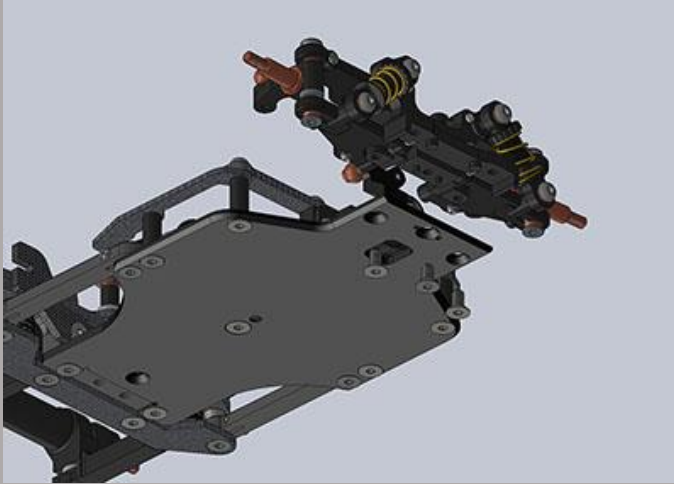

ASSEMBLY INSTRUCTIONS

Lastly we will build and install the front end.

If you are building a double A-Arm car, the manual link is here:

[RX28G2 DAA Front End Manual V2.0](#)

If you are building the K Front end, the manual is here:

[RX28 KISS FRONT END MANUAL](#)

Once assembled, install the front end with 3pcs of the M2x4CS (RX28-023).

Now build your turnbuckles (RX28-043) by threading the ball cups into the rods.

Next, pop the turnbuckles into the previously installed pivot balls on the knuckles and steering horn. Take note of the orientation of the Turnbuckles. The grooves on the rods are offset to one side. Make sure you install them facing the same direction so that when adjusting, you are going the same way to make them longer or shorter. To start off we suggest a starting setting of 0 degrees of Toe Out.

RX28

WORLDS EDITION

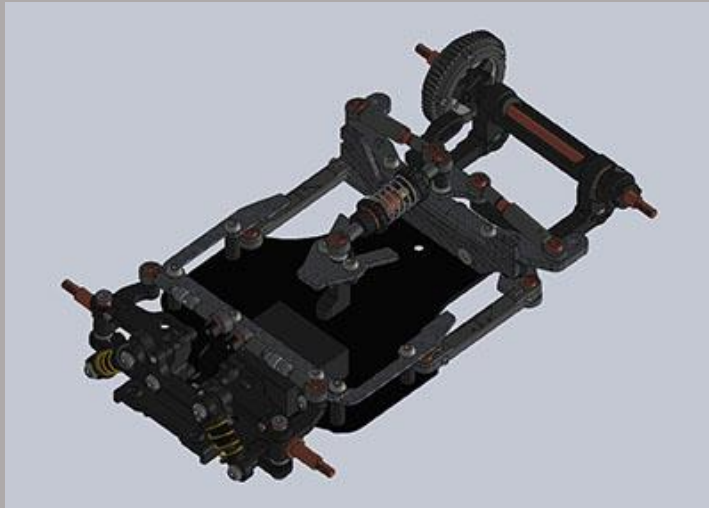

ASSEMBLY INSTRUCTIONS

You are done! Now install your favorite electronics and go win some races!

PNWC "WORLDS" SS SET-UP:

FRONT:

- Pink front springs
- 15,000 Grease
- Center Hole Upper Tower
- Black Arms Top/Bottom
- 0.2mm Droop ORH
- 2.0mm RH
- Reflex RX604-40 Tire 22.8mm
- Reflex 22.60 Disc
- Reflex RX511 Jomurema Front Bumper.
- All else stock

CENTER:

- 0.5mm droop
- Silver spring
- 15,000 grease

REAR:

- 2.0mm RH
- 15,000 Grease
- Marka 15-degree Radial
- Reflex Racing Gear Diff (RX538) with Reflex RX413 Ceramic Grease
- All else stock

BODY: Jomurema GT-01 with Lexan Roof and Mako X Rear Wing. 25g.